

Ground Floor
59.5sqm
Total Floor Area 111.5m²

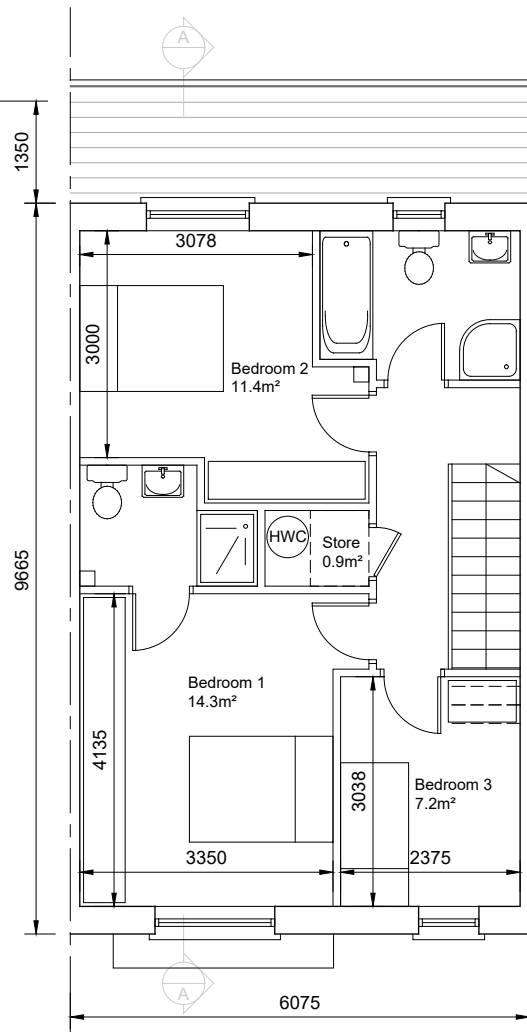

First Floor
52.0sqm



FRONT ELEVATION



REAR ELEVATION

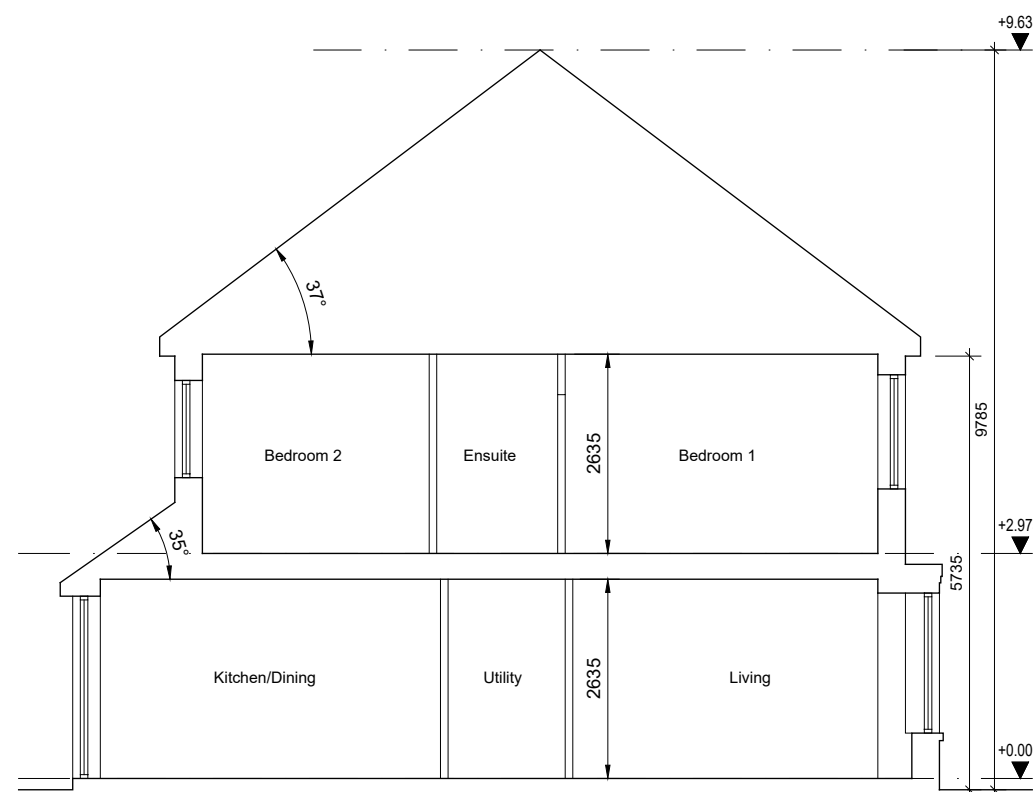

SECTION A-A

- © This drawing is copyright.
 1 Do not scale this drawing.
 2 Errors and omissions to be immediately notified to Architect.
 3 All dimensions to be checked on site.
 4 To be read with relevant Engineers drawings.

- Notes:**
 1. All dimensions in millimetres.
 2. North point orientation / levels as per site plan.
 3. This Housetype may be handed. See site layout plan.

- External Finishes:**
 Roof:
 Fibre-cement slates.
 Walls:
 Painted render finish
 Selected facing brick
 Windows:
 uPVC or timber framed
 Gutters/downpipes:
 uPVC or aluminium
 Front Door:
 Selected coloured composite or painted timber door with fanlight and/or sidelight and/or glazed light in leaf

revisions	date	ins
description		
HOUSETYPE N1		
PLANS, SECTION & ELEVATIONS		
job		scale
Development at Academy Street Navan		100@A3
client		date
COINDALE LTD.		NOV '19
issue		drawn
PLANNING		PMV
checked		MC
drawing no.		1828 P N1-100
date		11/01/2020
ins		PMV
checked		MC
<p>CONROY CROWE KELLY ARCHITECTS & URBAN DESIGNERS</p> <p>65 MERRION SQUARE DUBLIN 2</p> <p>phone 01 6613990 fax 01 6765715 email info@cck.ie</p>		